

Installation Instructions:

Ducted - Modular

U Channel

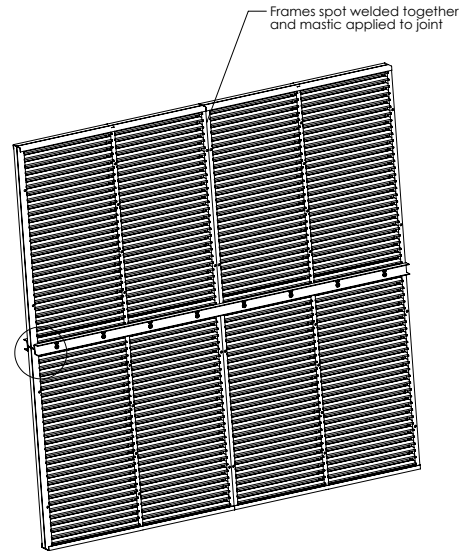
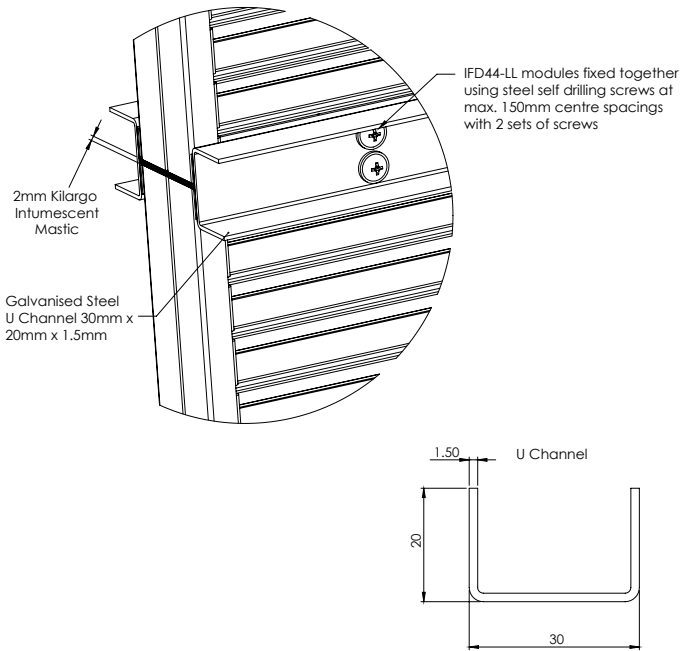

- Step 1** Apply Kilargo Intumescent Mastic to the opposing module.
- Step 2** Align and bring modules together and mechanically fix together using U channels and steel self-drilling screws or steel pop rivets with 2 sets of screws at 150mm centres as per the modular system drawing on both sides.
- Step 3** Fix modular damper to aperture or casing as shown in the appropriate system drawing and installation instructions.

System Notes

- Fixings are to be supplied by others.
- Optional flat joining strips supplied at the time of order in lieu of U channel on request for air transfer systems only.

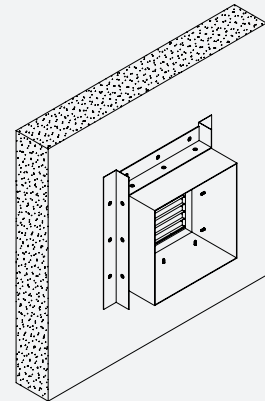

Building element:	Hebel
Application:	Mounted in casing DD / DG in 75SW system hebel wall
Maximum size:	300 x 300 *without build up
FRL	-/120/-
Test reference No.	FAS200229

*Max size 1200 x 1200 if wall thickness is built up locally with 100mm wide FR plasterboard to a minimum thickness of 116mm

Note: To be read in conjunction with system WH11 (a)

System No. WH11 (b)